

SCHEDULE OF DOORS & WINDOWS

SR. NO.	TYPE	WIDTH	HEIGHT	STILL LVL	UP/LVL	DESCRIPTION
01	D	7'	4'10"	0'	7'	PULLY FANFOLD DOORS
02	D	7'	4'10"	0'	7'	PULLY FANFOLD DOORS
03	D	7'	4'10"	0'	7'	PULLY FANFOLD DOORS
04	W	7'	7'	7'	7'	PULLY GLAZED WINDOWS
05	W	7'	7'	7'	7'	PULLY GLAZED WINDOWS
06	W	7'	7'	7'	7'	PULLY GLAZED WINDOWS
07	W	7'	7'	7'	7'	PULLY GLAZED WINDOWS

SPECIFICATION

1. RCC ON PILE FOUNDATION
2. IN CLASS BRICK WORK IN CONCRETE MORTAR OR SUPER STRUCTURE
3. ROOFING OF PLASTER FOR AREA WINDOW SECTION
4. AS PER I.P.S. FLOORING OVER IS DAY RANDED GROW OVER PLAT BRICK
5. SCALD OVER LOCAL SAND FILL
6. 10 CM THICK AS 1:3:6 TROWELING OVER 18 CM R.C.C. ROOF SLAB
7. CHROME PLATE & BRITISHERS OF DOORS & WINDOWS TO BE
8. IN CONCRETE MORTAR WITH 10% OF WALL
9. IN CONCRETE MORTAR WITH 10% OF WALL
10. WHITE & COLOUR VARI AS PER CHOICE

AREA CALCULATION

TOTAL PLOT AREA	91019.54 B
PROP. G.FLOOR B.U AREA	11699.54 B
PROP. 1ST FLOOR B.U AREA	11699.54 B
TOTAL B.U. AREA	23399.50 FT

PLOT DETAIL:-

PROPOSED SCHOOL BUILDING PLAN OF LAND OWNER - MURLI CH EDUCATION TRUST
 SCHOOL NAME - ST. JOSEPH PUBLIC SCHOOL
 AT VILLAGE - ANBA BAJAR
 KHATA NO. - 4131/03
 PLOT NO. - 4131/04
 THANA NO. - 465
 P.S. ANBA
 DIST. - AURANGABAD (BIHAR)

SCALE 1"=10'
 NORTH
 SING OF ENG.



[Signature]

Executive Engineer
Building Construction Dept.
Aurangabad Bihar

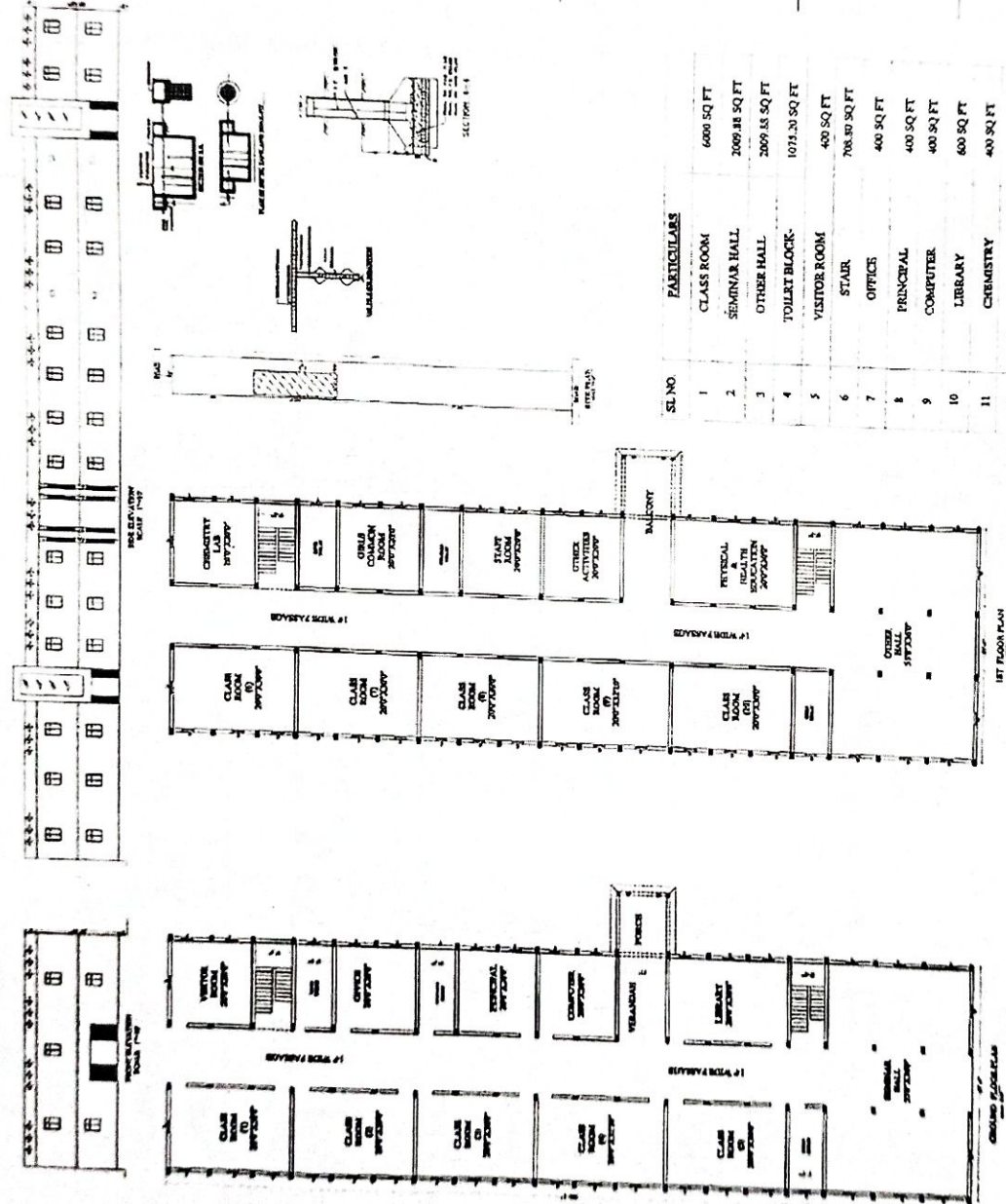

SL. NO.	PARTICULARS	AREA (SQ. FT.)
1	CLASS ROOM	6000 SQ. FT.
2	SEMINAR HALL	2000 SQ. FT.
3	OTHER HALL	2000 SQ. FT.
4	TOILET BLOCK	1025.20 SQ. FT.
5	VISITOR ROOM	400 SQ. FT.
6	STAIR	708.30 SQ. FT.
7	OFFICE	400 SQ. FT.
8	PRINCIPAL	400 SQ. FT.
9	COMPUTER	400 SQ. FT.
10	LIBRARY	600 SQ. FT.
11	CHEMISTRY	400 SQ. FT.
12	GIRLS CONGRAN ROOM	400 SQ. FT.
13	STAFF ROOM	400 SQ. FT.
14	OTHER ACTIVITIES	400 SQ. FT.
15	PHYSICAL & HEALTH EDUCATION	400 SQ. FT.